









# SUCCESS

3 and 5-axis robots for 60 to 900 tons  
Injection Molding Machines

YOUR AFFORDABLE TECHNOLOGICAL BREAKTHROUGH

 11	 11 
 22	 22 
 33	 33 



The Success Line has been completely redesigned by Sepro. This best-seller is now also available in a 5-axis version, making best-in-class technology more affordable and more compact.

Available for IMMs from 60 to 900 tons  
Enhanced Gripping components: larger capacity, more compact  
Cam followers technology: SLS (Sepro Linear System)™

EXPERIENCE FULL CONTROL

# SUCCESS

YOUR AFFORDABLE TECHNOLOGICAL BREAKTHROUGH



## The recognized reliability of a best-seller

Experience the complete redesign of one of Sepro's best sellers, designed for IMM from 60 to 900 tons

- Modular Platform to cover more than 90% of customer's needs:
- Outstanding reliability with the cam followers technology: SLS (Sepro Linear System)™
- Enhanced Gripping components: larger capacity, more compact.
- More compact foot print

The Success offer is perfectly adapted to all your simple pick-and-place and regular stacking applications

Thanks to the Touch 2 control system, it is easy and friendly to use

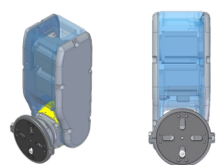

## Success Line X: the new servo-wrist

The new Success servo-wrist is co-developed with Yaskawa and is available on **SUCCESS LINE X**

High torque, high accuracy, compact design, available on all Success range: Success 11X, Success 22X, Success 33X

## New compact Z-box integration

This configuration is more compact, allowing the integration of

- Up to 8 vacuum and 8 pressure circuits as a standard option
  - Pneumatic or servo rotation control.
- Available on all robots of all Success ranges.

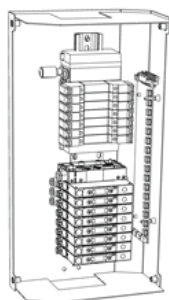

## Smart lubrication system

With the new Success lines comes a new lubrication system for the cam followers.

- Easy and quick maintenance
- Changed only once a year



## Introducing a technological breakthrough

Success Line X, the 5-axis version of the Success robots benefits from the very latest technology, as well as the reliable and high-performance mechanical designs developed by our design offices

- An affordable high-end robot
- A very flexible solution for the customer
- A servo rotation from 6 axis Yaskawa: accuracy and reliability

Sepro Group is convinced that 5-servo-axis Cartesian robots represent the future of injection-molding automation.



## Y free Motion: always available!

The Y free function is a Sepro manufacturing standard.

It simplifies the programming of part accompaniment during ejection and can reduce the cost of your EOATs (simplified design).



## Compact beam-mounted control cabinet

Redesigned cabinet for better accessibility and maintenance. Also available for the 5-axis Success line.

The compact control cabinet is mounted on the end of the beam as standard. Its innovative feature is its flexible installation, as it can be installed on the left or right, depending on your setup, to free floor space.

SUCCESS IS EQUIPPED WITH THE TOUCH 2 CONTROL SYSTEM AS STANDARD

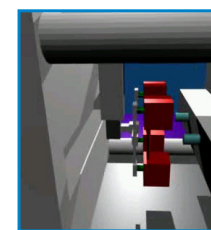

## Simply Intuitive

With the Simple Pick-and-Place Module, create your cycle by just answering the system's questions and see the result immediately in 3D on the video (Simple Pick-and-Place and regular stacking).



## «What you see is what you get»

Make your daily routine easier :

- When fine-tuning, the joystick makes delicate settings in the mold possible
- The large, 10" LCD screen gives you clear and precise information
- The documentation can be consulted on line when you want
- If a fault appears, troubleshooting data is displayed automatically
- Thanks to the USB key, operators, setters, programmers and maintenance staff have direct access to the relevant data
- Eco Mode: Once the cycle is started, a single key can reduce energy consumption and extend your robot's working life
- Digital vacuum switch (option): set and save your part grip settings for each mold directly on the pendant

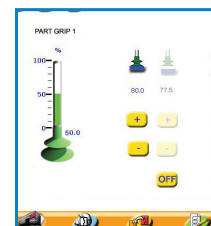

## Tried and tested ergonomics

Task-based navigation means you can directly access the job to be done :

- Production
- Mold Change
- Programming
- Maintenance

## FROM TOUCH 2 TO VISUAL 2

For your complex applications, Success can be equipped with Visual 2 : a modular offer that can evolve over time.

- A PLC associated with each application to manage your stacking or insert distribution peripherals
- Possible to associate up to 3 simultaneous subroutines with the robot's program and the PLC
- Manage up to 1000 different applications (100 on Touch 2)
- Make mold changes completely safe using mold encoding and/or EOAT encoding (encoded plug)



# SUCCESS

	Success 11	Success 22	Success 33	Success 11 X	Success 22 X	Success 33 X
Mold clamping force - Indication metric Tons	60 - 200	150 - 500	350 - 900	60 - 200	150 - 500	350 - 900
Mold clamping force - Indication US tons	66 - 220	165 - 550	385 - 990	66 - 220	165 - 550	385 - 990
Horizontal stroke (mm) (1)	1000 - 4000	1500 - 6000	2000 - 7000	1000 - 4000	1500 - 6000	2000 - 7000
Maximum instantaneous speed (m/s)	2	2	2	2	2	2
Demold stroke (mm) (LD(2))	500 - 700(LD)	700 - 900(LD)	900 - 1100(LD)	500 - 700(LD)	700 - 900(LD)	900 - 1100(LD)
Maximum instantaneous speed (m/s)	2	2	2	2	2	2
Vertical direct arm	✓	✓	✓	✓	✓	✓
Vertical stroke (mm)	1200	1400	1600	1200	1400	1600
Maximum instantaneous speed (m/s)	3	3	3	3	3	3
R1 pneumatic rotation (0-90°)	✓	✓	✓	N/A	N/A	N/A
R1 (0-180°) + R2 (0-270°) servomotor rotation	N/A	N/A	N/A	✓	✓	✓
Maximum load (parts + EOAT) (kg) (HL(3))	6	10	15	6	10	15 - 20(HL)
Compact beam-mounted control cabinet	✓	✓	✓	✓	✓	✓
TOUCH 2 control system	✓	✓	✓	✓	✓	✓

## OPTIONS

Part grip - Vacuum + pressure circuits MAXI	8 + 8					
Vertical telescopic arm	✓	✓	✓	✓	✓	✓
Vertical stroke (mm)	1200 - 1400	1400-1600	1800	1200 - 1400	1400-1600	1800
Maximum instantaneous speed (m/s)	3	3	3	3	3	3
R2 pneumatic rotation (0-90°-180°)	0	0	0	N/A	N/A	N/A
Smart vacuum switch	✓	✓	✓	✓	✓	✓
Floor-standing control cabinet	✓	✓	✓	✓	✓	✓
VISUAL 2 control system	✓	✓	✓	✓	✓	✓

(1) Can be adapted by 500 mm steps

(2) Long Demolding Version

(3) Heavy Load Version



## WHY CHOOSE SEPRO ?

- ✓ Sepro manufacturer n°1 in Europe - Major performer in North and South America
- ✓ Main supplier for the Automotive, Medical and Packaging industries in Europe and the USA
- ✓ A full line of robots from 3 to 6 axis with a smart and user-friendly control
- ✓ Over 40,000 installations worldwide



EXPERIENCE FULL CONTROL

[www.sepro-group.com](http://www.sepro-group.com)